



# Pneumatic atomizing nozzles, Flat fan, pressure principle, internal mixing Series 136.4



**Particularly fine flat fan atomization with air or gas.**  
**Siphon principle.**  
**Internal mixing of fluids.**

Applications:  
Web dampening, cooling,  
humidification of goods.

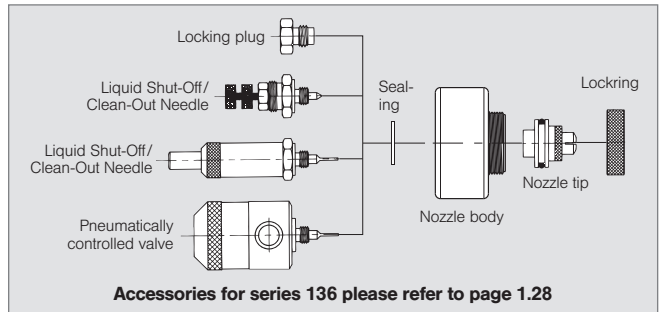
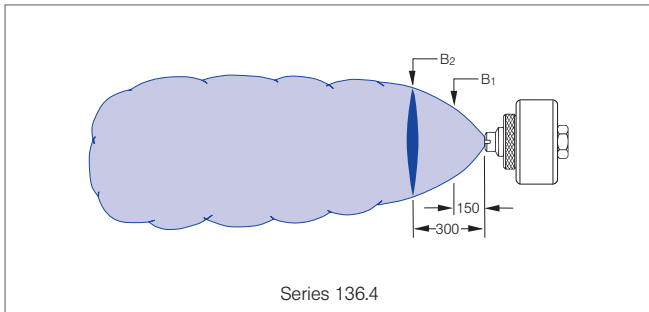
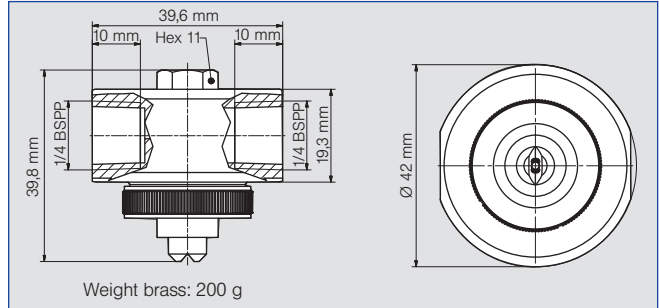

Spray angle	Ordering no.		E Ø [mm]	Liquid pressure p [bar]												Spray dimensions					
	Type	Mat. no.		0.7			1.5			3.0			4.0			p Air [bar]	p Water [bar]	B1 [mm]	B2 [mm]		
				p Air [bar]	V̇ Water [l/h]	V̇n Air [m³/h]	p Air [bar]	V̇ Water [l/h]	V̇n Air [m³/h]	p Air [bar]	V̇ Water [l/h]	V̇n Air [m³/h]	p Air [bar]	V̇ Water [l/h]	V̇n Air [m³/h]						
45°	136. 414. xx. A2	○ ○	0.7	1.00	7.70	1.30	1.40	14.30	1.50	2.20	22.40	2.00	3.00	25.10	2.50	1.40	0.70	85	125		
				1.20	6.00	1.50	1.60	13.00	1.60	2.60	20.00	2.30	3.40	23.00	2.80	2.40	1.50	100	145		
				1.40	4.20	1.70	1.80	11.60	1.80	3.00	17.70	2.60	3.80	20.90	3.10	3.20	2.00	105	155		
				1.60	2.70	1.90	2.00	10.20	2.00	3.40	15.50	3.00	4.20	18.90	3.50	3.80	3.00	120	170		
				1.80	1.30	2.10	2.20	8.90	2.20	3.80	13.30	3.40	4.60	16.90	3.80	4.60	4.00	130	210		
				-	-	-	2.40	7.40	2.40	4.20	11.00	3.70	5.00	14.90	4.20	-	-	-	-	-	-
				-	-	-	2.60	5.90	2.60	4.60	8.80	4.10	5.40	12.80	4.60	-	-	-	-	-	-
	-	-	-	2.80	4.60	2.80	5.00	6.60	4.50	5.80	10.80	5.00	-	-	-	-	-	-			
	-	-	-	3.00	3.20	3.00	5.40	4.30	4.90	6.00	9.80	5.20	-	-	-	-	-	-			
	-	-	-	3.20	2.10	3.20	5.80	2.50	5.30	-	-	-	-	-	-	-	-	-			
	-	-	-	3.40	1.10	3.40	6.00	1.60	5.50	-	-	-	-	-	-	-	-	-			
	-	-	-	1.20	13.90	1.50	1.60	26.60	1.60	3.00	37.10	2.60	3.60	45.60	2.90	1.20	0.70	110	165		
	-	-	-	1.40	11.90	1.70	1.80	24.30	1.80	3.40	33.10	3.00	4.00	41.90	3.30	2.00	1.50	115	190		
	-	-	-	1.60	9.50	1.90	2.00	22.00	2.00	3.80	29.50	3.40	4.40	38.30	3.70	2.80	2.00	145	190		
-	-	-	1.80	7.80	2.10	2.20	19.90	2.20	4.20	26.20	3.80	4.80	35.00	4.00	3.80	3.00	150	210			
-	-	-	-	-	-	2.40	18.00	2.40	4.60	23.00	4.20	5.20	31.80	4.50	4.80	4.00	160	230			
-	-	-	-	-	-	2.60	16.20	2.60	5.00	20.20	4.60	5.60	29.00	4.90	-	-	-	-			
-	-	-	-	-	-	2.80	14.40	2.80	5.40	17.60	4.90	6.00	26.20	5.20	-	-	-	-			
-	-	-	-	-	-	3.00	12.80	3.00	5.80	14.90	5.30	-	-	-	-	-	-	-			
-	-	-	-	-	-	3.20	11.30	3.20	6.00	14.10	5.50	-	-	-	-	-	-	-			
-	-	-	-	-	-	3.40	9.90	3.40	-	-	-	-	-	-	-	-	-	-			
-	-	-	-	-	-	3.60	8.80	3.60	-	-	-	-	-	-	-	-	-	-			

E = narrowest free cross section (water)

Continued on next page.

**Example**    **Type**                    + **Material no. (xx)** = **Ordering no.**  
**for ordering:** 136. 414. xx. A2 + 1Y                    = 136. 414. 1Y. A2



