



Pneumatic atomizing nozzles, Full cone, pressure principle, internal mixing Series 166.2



Version with magnetic valve.
Fine full cone atomization and fogging with air or gas.
Especially wide spray angle of 60°.

Pressure principle.
Internal mixing of fluids.

Applications:
Humidification of air, cooling.

Technical Datas:

- Service pressure: 0-6 bar
- Voltage: 24 V DC
- Power: 8 W
- Switching frequency: ca. 500/min
- Protective System: IP 67
- Ambient temperature: 10°C / +50°C
- Material of gasket: EPDM

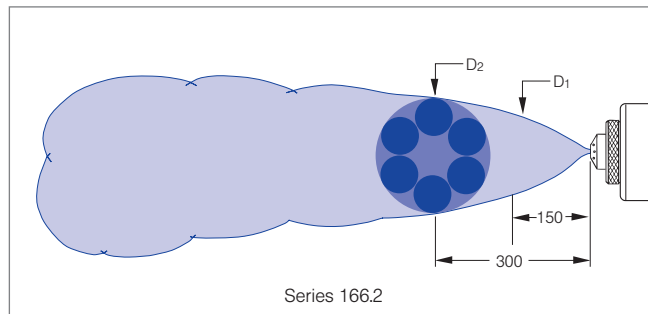
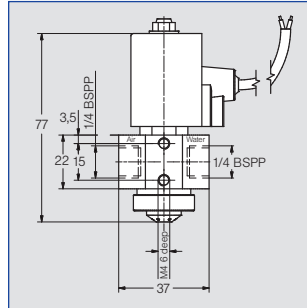

Accessories for series 166 please refer to page 1.29

Spray angle	Ordering no.		E ∅ [mm]	Liquid pressure p [bar]												Spray dimensions					
	Type	Mat. no.		0.7			1.5			3.0			4.0			p Air [bar]	p Water [bar]	D1 [mm]	D2 [mm]		
				p Air [bar]	V̇ Water [l/h]	V̇n Air [m³/h]	p Air [bar]	V̇ Water [l/h]	V̇n Air [m³/h]	p Air [bar]	V̇ Water [l/h]	V̇n Air [m³/h]	p Air [bar]	V̇ Water [l/h]	V̇n Air [m³/h]						
60°	166. 215. xx. A2	○	16	AISI 303	0.5	1.00	3.00	1.30	1.60	5.80	1.70	2.80	8.50	2.40	3.80	9.40	3.10	1.00	0.70	200	330
						1.20	1.80	1.50	1.80	4.90	1.90	3.20	7.20	2.80	4.20	8.20	3.50	1.60	1.50	230	380
						1.40	0.70	1.80	2.00	3.80	2.10	3.60	5.70	3.20	4.60	6.90	3.90	2.40	2.00	230	385
						-	-	-	2.20	2.80	2.30	4.00	4.00	3.60	5.00	5.40	4.20	3.20	3.00	245	390
						-	-	-	2.40	1.70	2.50	4.40	2.20	4.10	5.40	3.80	4.70	4.20	4.00	250	410
						-	-	-	2.60	0.80	2.80	4.80	0.80	4.50	5.80	2.30	5.20	-	-	-	-
	166. 222. xx. A2	○	16	AISI 303	1.0	0.80	17.50	2.80	1.60	25.90	4.00	3.00	40.40	5.80	3.80	54.90	6.40	0.80	0.70	250	450
						1.00	6.00	4.30	1.80	14.70	5.30	3.20	31.50	6.90	4.00	45.60	7.30	1.60	1.50	245	465
						-	-	-	2.00	6.70	6.70	3.40	22.20	8.20	4.20	37.60	8.50	2.30	2.00	245	465
						-	-	-	2.20	1.90	8.10	3.60	14.60	9.50	4.40	29.60	9.70	3.20	3.00	250	465
						-	-	-	-	-	-	3.80	8.50	11.00	4.60	21.60	11.20	4.20	4.00	245	465
						-	-	-	-	-	-	4.00	4.50	12.30	4.80	15.30	12.40	-	-	-	-
	166. 231. xx. A2	○	16	AISI 303	1.4	1.60	25.60	5.10	2.60	44.20	7.00	3.60	93.70	7.90	4.20	132.90	7.30	2.00	0.70	235	380
						2.00	17.80	6.20	3.00	33.00	8.20	4.00	78.30	9.30	4.60	117.20	9.00	2.60	1.50	245	415
						2.40	11.30	7.20	3.40	24.70	9.20	4.40	65.80	10.60	5.00	101.10	10.40	2.40	2.00	255	420
						2.80	6.90	8.10	3.80	18.10	10.20	4.80	54.90	11.90	5.40	87.90	11.80	3.60	3.00	255	425
						-	-	-	4.20	13.20	11.20	5.20	45.60	13.00	5.80	76.60	13.20	4.20	4.00	265	430
						-	-	-	4.60	9.30	12.00	5.60	38.00	14.10	6.00	71.20	13.80	-	-	-	-

E = narrowest free cross section (water)

Example **Type** + **Material no. (xx)** = **Ordering no.**
for ordering: 166. 215. xx. A2 + 16 = 166. 215. 16. A2

