

140  
1879 - 2019

ENGINEERING  
YOUR SPRAY SOLUTION



NEW 

## Pop-up rotating cleaning nozzles Series 5P2/5P3 ATEX version

### »PopUp Whirly«

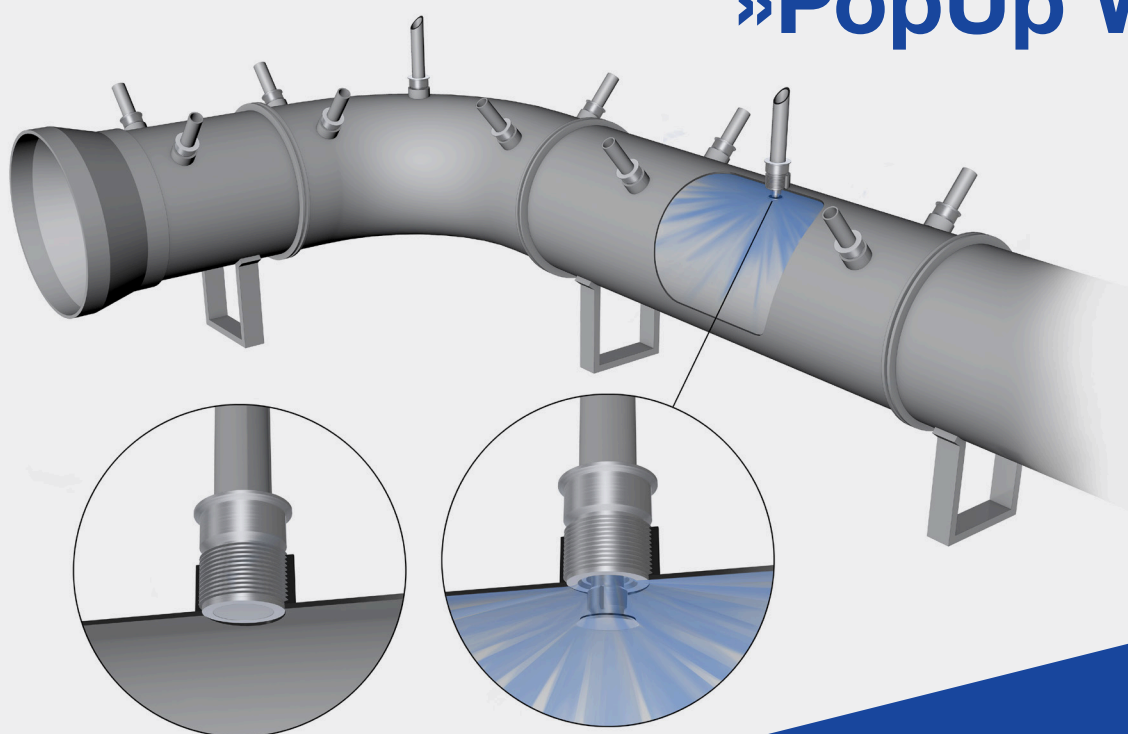

Pops up, cleans, disappears

- Flush-mounted installation
- Pops up only for cleaning
- Perfect for confined spaces



### Series 5P2/5P3

The PopUp Whirly is designed for cleaning in confined spaces and for tanks or pipelines where conventional cleaning systems could affect the process. The free-spinning rotating nozzle can be installed flush with the wall. When a certain liquid pressure is applied, the rotating cleaning nozzle of the PopUp Whirly extends automatically and starts cleaning. The PopUp Whirly is also suitable for pipe cleaning and for applications that use foam. It is particularly interesting for applications in the food and beverage industry as well as in the chemical and pharmaceutical industry. The ATEX approval makes the PopUp Whirly suitable for use in explosive areas.

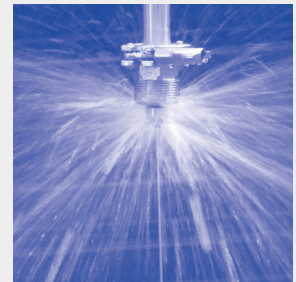
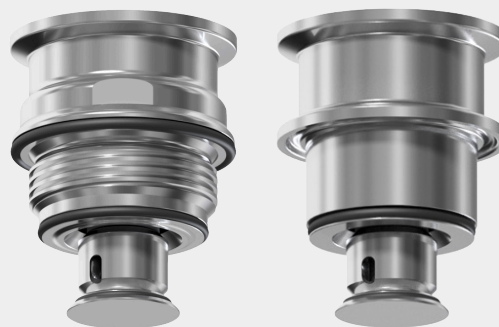

#### Function video

Scan the QR-code or go to:  
[www.lechler.com/popupwhirly](http://www.lechler.com/popupwhirly)



	<b>Max. tank diameter [m]</b>	0	1	2	3	4	5	6	7	8	9
--	-------------------------------	---	---	---	---	---	---	---	---	---	---



#### Materials

316L SS,  
316Ti SS (spring),  
316 SS (snap ring),  
FKM (O-rings)



#### Max. temperature

140 °C



#### Recommended operating pressure

2 bar  
5P2:  
opening pressure  
approx. 1.0 bar  
closing pressure  
approx. 0.5 bar  
5P3:  
opening pressure  
approx. 0.9 bar  
closing pressure  
approx. 0.5 bar



#### Installation

Operation in every  
direction is possible



#### Filtration

Line strainer with a mesh  
size of 0.3 mm/50 Mesh



#### Bearing

Slide bearing  
made of hardened  
stainless steel

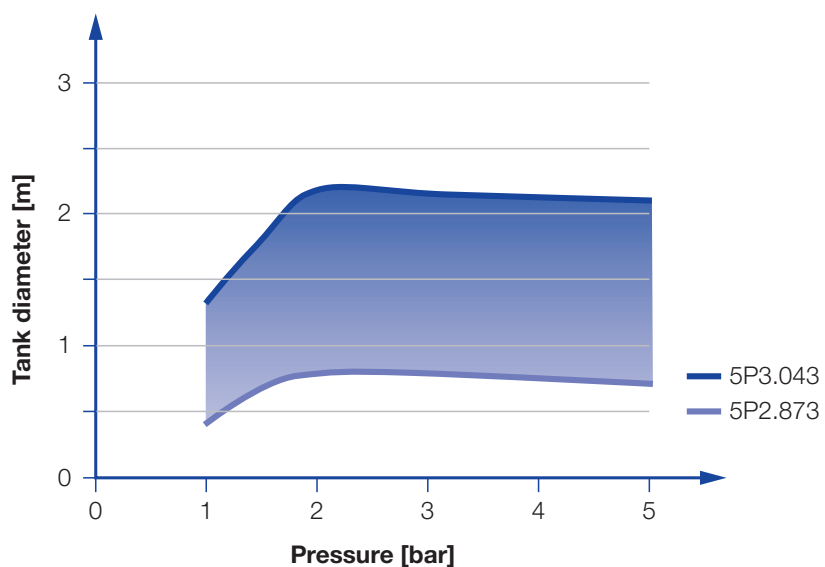



Overview of the tank diameter, depending upon the pressure of series 5P2/5P3

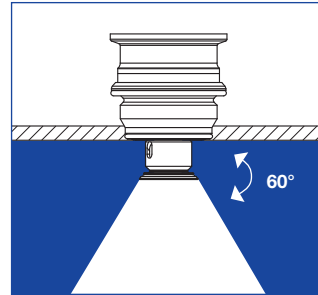
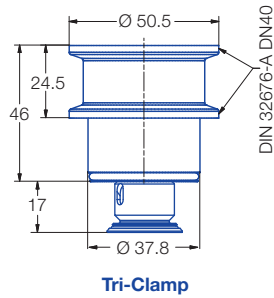
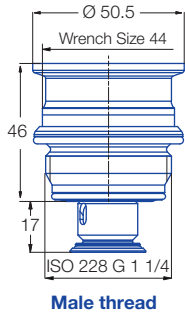

### Series 5P2





Spray angle 	Ordering no.	Tank connection		E Ø [mm]	V̇ [l/min]				Max. tank diameter [m]
		p [bar] (p <sub>max</sub> = 6 bar)							
		1 1/4 BSPP	Tri- Clamp		1	2	3	at 40 psi [US gal./ min]	
	5P2.873.1Y.AP.EX	○	-	3.0	10.6	15.0	18.4	5	0.8
	5P2.873.1Y.00.EX	-	○	3.0	10.6	15.0	18.4	5	0.8
	5P2.923.1Y.AP.EX	○	-	3.5	14.1	20.0	24.5	6	1.0
	5P2.923.1Y.00.EX	-	○	3.5	14.1	20.0	24.5	6	1.0

The maximum tank diameter shown above applies for the recommended operating pressure and is indicative only. The cleaning result is also affected by the type of soiling.

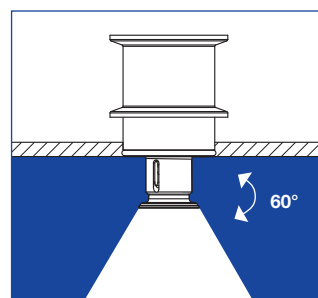
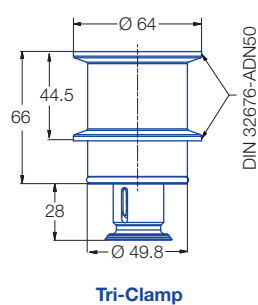
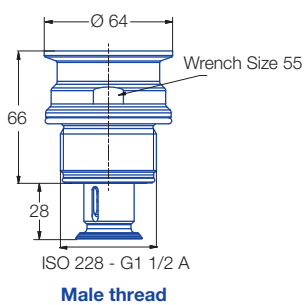
### Series 5P3



Spray angle 	Ordering no.	Tank connection		E Ø [mm]	V̇ [l/min]				Max. tank diameter [m]
					p [bar] (p <sub>max</sub> = 6 bar)				
		1 1/2 BSPP	Tri- Clamp		1	2	3	at 40 psi [US gal./ min]	
	5P3.043.1Y.AR.EX	●	-	3.3	28.3	40	49	12	2.2
	5P3.043.1Y.00.EX	-	○	3.3	28.3	40	49	12	2.2

The maximum tank diameter shown above applies for the recommended operating pressure and is indicative only. The cleaning result is also affected by the type of soiling.

## Nozzle installation

With thread

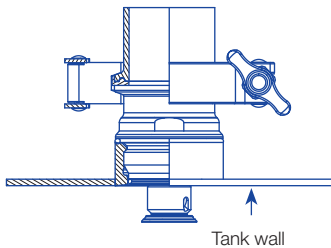

With Tri-Clamp

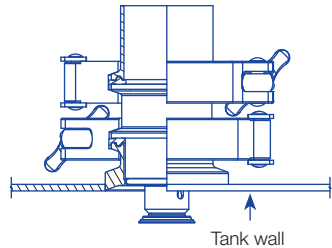

### Information on operation

- The PopUp Whirly is not suitable for operation with compressed air or any other gas.
- Operation above the recommended operating pressure has negative effects on the cleaning result and wear.

## Weld-in flange for Tri-Clamp-Version

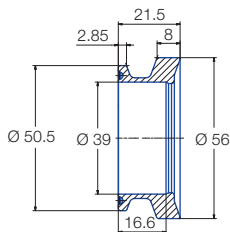

**5P2**

**Ord.-no.** 050.020.1Y.01.00

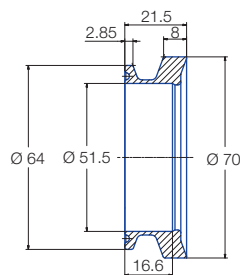

**5P3**

**Ord.-no.** 050.020.1Y.01.01

### Information

Gasket with a thickness of 2 mm must be used if the PopUp Whirly is installed with this weld-in flange.

### Material

316L SS

## Weld-in socket for Thread-Version

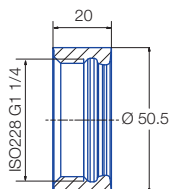

**5P2**

**Ord.-no.** 050.020.1Y.AQ.00

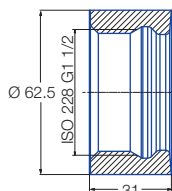

**5P3**

**Ord.-no.** 050.020.1Y.AS.00

### Information

The thread is hygienically sealed with 2 O-rings included in the scope of delivery.

### Material

316L SS

### Unit group/category/zones

Ex II 1G Ex h IIB T3 Ga

Ex II 1D Ex h IIIC T140 °C Da